

Totaline® Is Your Compressor Warehouse



Danfoss Universal Scrolls

Replacements for Trane Commercial Scrolls



9 Ton—230V

General Characteristics

Model Number	SM115-3QAI
Trane Model	CSHA093J & R
Capacity at rating conditions	115,000 BTU/hr
Suction and discharge Connections	Brazed
Suction connection	1-3/8" ODF
Discharge connection	7/8" ODF
Oil sight glass	Threaded
Oil equalization line	3/8" tube
Oil drain connection	1/4" NPT
LP gauge port	None
IPR valve	None
Swept volume	9.46 in ³ /rev
Displacement @ Nominal speed	1149 cfm @ 3500 rpm
Net weight	172 lbs
Oil charge	128 oz Mineral - 160P
Maximum system test pressure Low Side / High Side	363 psi / 464 psi
Maximum differential test pressure	348 psi
Maximum number of starts per hour	12
Refrigerant charge limit	24 lbs
Approved refrigerant	R22

Electrical Characteristics

Nominal voltage	200-230V/3/60Hz
Voltage range	180-253V
Winding resistance (between phases) +/- 7% at 77F	0.26 Ohm
Maximum Must Trip current (MMT)	52 A
Locked Rotor Amps (LRA)	265 A
Motor protection	Internal thermostat, ext. overload protector needed

Recommended Installation Torques

Oil sight glass	37 ft. lbs
Power connections / Earth connection	2 ft. lbs / 1 ft. lbs
Terminal box cover screws	2 ft. lbs
Mounting bolts	15 ft lbs

Dimensions

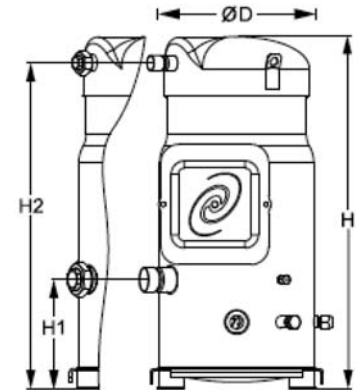

D=10 inch, H=23.1 inch,
H1=7.1 inch, H2=21.2 inch

Terminal box

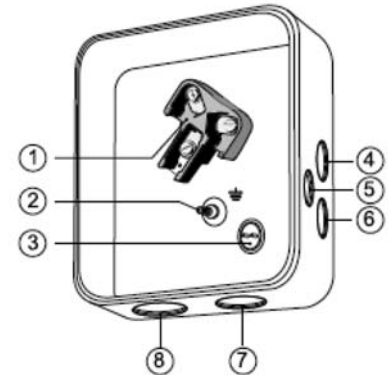

IP54 (with cable gland)

- 1: Power connection, 3 x 4.8 mm (3/16")
- 2: Earth M5, torque 2 Nm (17 in.lb)
- 3: Thermostat connector
- 4: Knock-out Ø 22 mm (7/8") for 1/2" conduit
- 5: Knock-out Ø 16.5 mm (0.65")
- 6: Knock-out Ø 20.5 mm (0.81")
- 7: Double knock-out Ø 32.1 mm (1.26") & Ø 25.4 mm (1")
- 8: Double knock-out Ø 44 mm (1-3/4") for 1-1/4" conduit & Ø 34 mm (1-3/8") for 1" conduit

9 Ton—230V

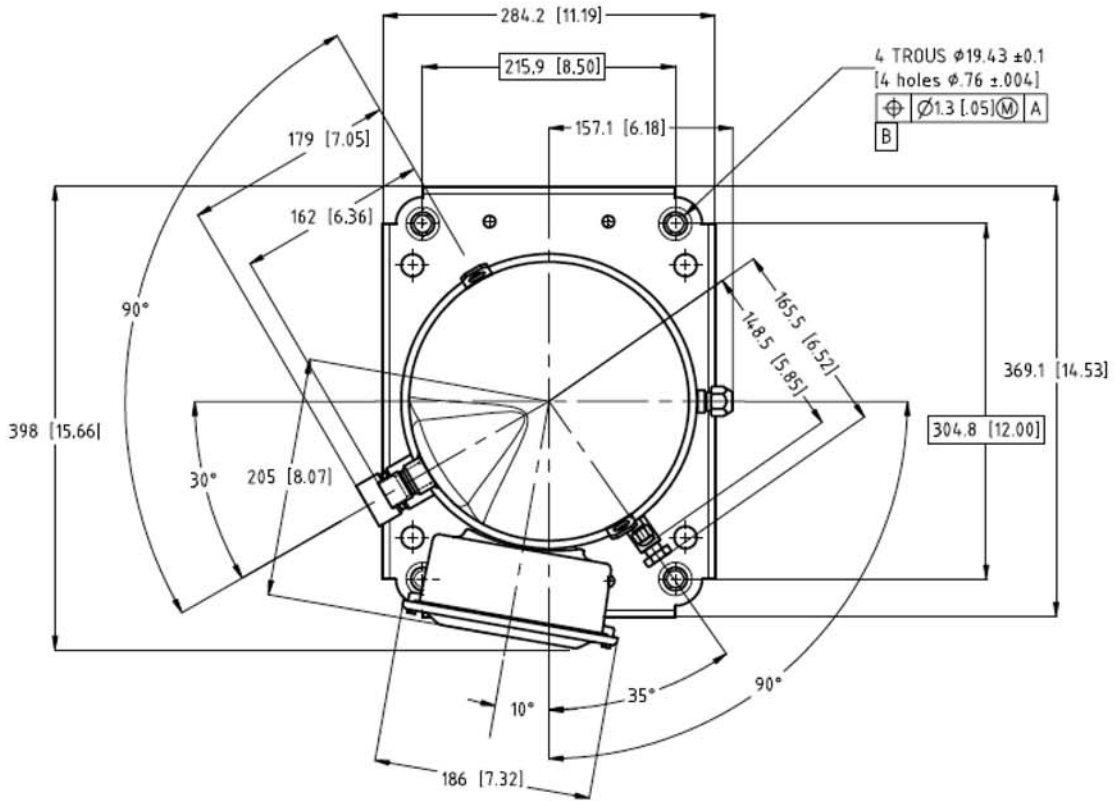
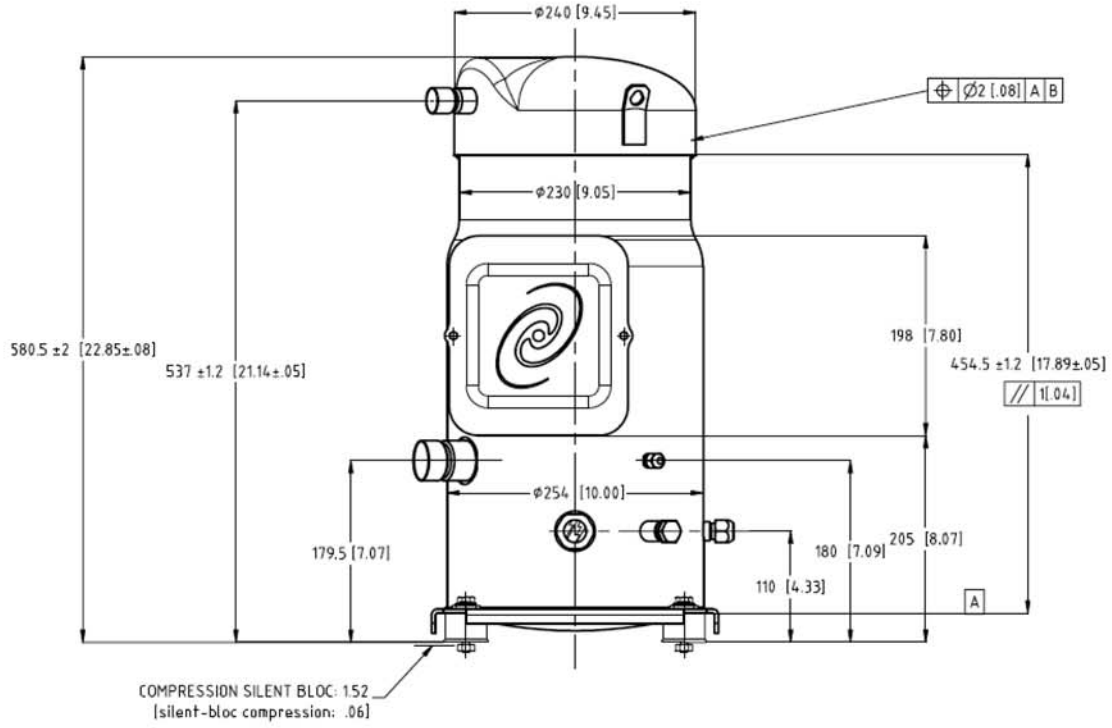

Note: Top mounting bracket not shown

9 Ton—460V

General Characteristics

Model Number	SM115-4QAI
Trane Model	CSHA093K
Capacity at rating conditions	115,000 BTU/hr
Suction and discharge Connections	Brazed
Suction connection	1-3/8" ODF
Discharge connection	7/8" ODF
Oil sight glass	Threaded
Oil equalization line	3/8" tube
Oil drain connection	1/4" NPT
LP gauge port	None
IPR valve	None
Swept volume	9.46 in ³ /rev
Displacement @ Nominal speed	1149 cfm @ 3500 rpm
Net weight	172 lbs
Oil charge	128 oz Mineral - 160P
Maximum system test pressure Low Side / High Side	363 psi / 464 psi
Maximum differential test pressure	348 psi
Maximum number of starts per hour	12
Refrigerant charge limit	24 lbs
Approved refrigerant	R22

Electrical Characteristics

Nominal voltage	460V/3/60Hz
Voltage range	414-506V
Winding resistance (between phases) +/- 7% at 77F	1.16 Ohm
Maximum Must Trip current (MMT)	25 A
Locked Rotor Amps (LRA)	120 A
Motor protection	Internal thermostat, ext. overload protector needed

Recommended Installation Torques

Oil sight glass	37 ft. lbs
Power connections / Earth connection	2 ft. lbs / 1 ft. lbs
Terminal box cover screws	2 ft. lbs
Mounting bolts	15 ft lbs

Dimensions

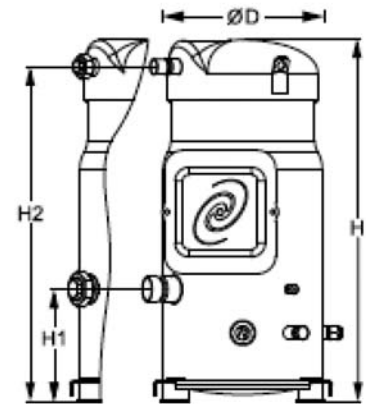

D=10 inch, H=23.1 inch,
H1=7.1 inch, H2=21.2 inch

Terminal box

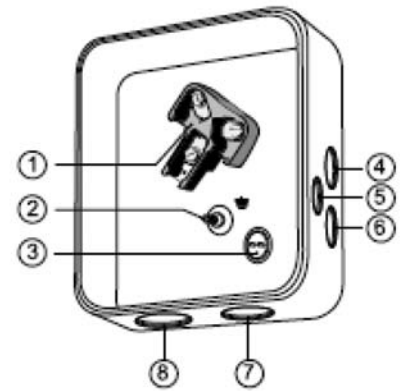

IP54 (with cable gland)

- 1: Power connection, 3 x 4.8 mm (3/16")
- 2: Earth M5, torque 2 Nm (17 in.lb)
- 3: Thermostat connector
- 4: Knock-out Ø 22 mm (7/8") for 1/2" conduit
- 5: Knock-out Ø 16.5 mm (0.65")
- 6: Knock-out Ø 20.5 mm (0.81")
- 7: Double knock-out Ø 32.1 mm (1.26") & Ø 25.4 mm (1")
- 8: Double knock-out Ø 44 mm (1-3/4") for 1-1/4" conduit & Ø 34 mm (1-3/8") for 1" conduit

9 Ton—460V

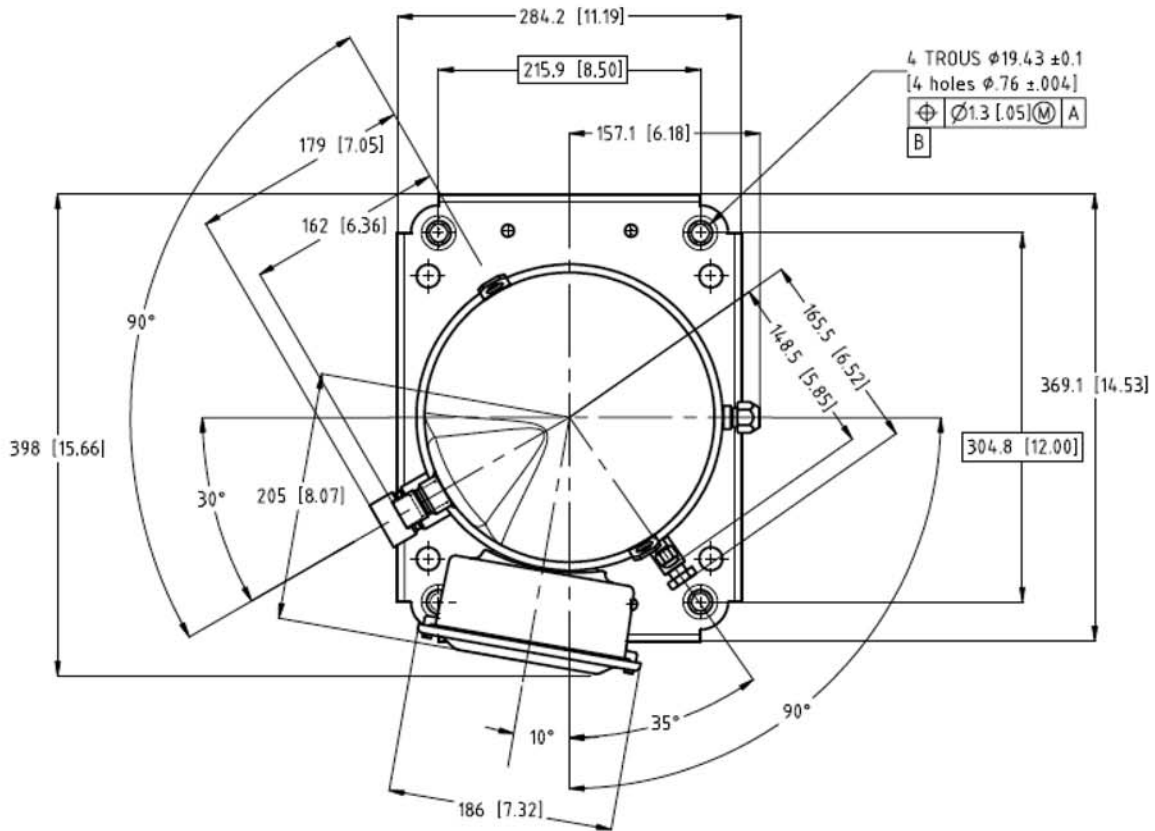
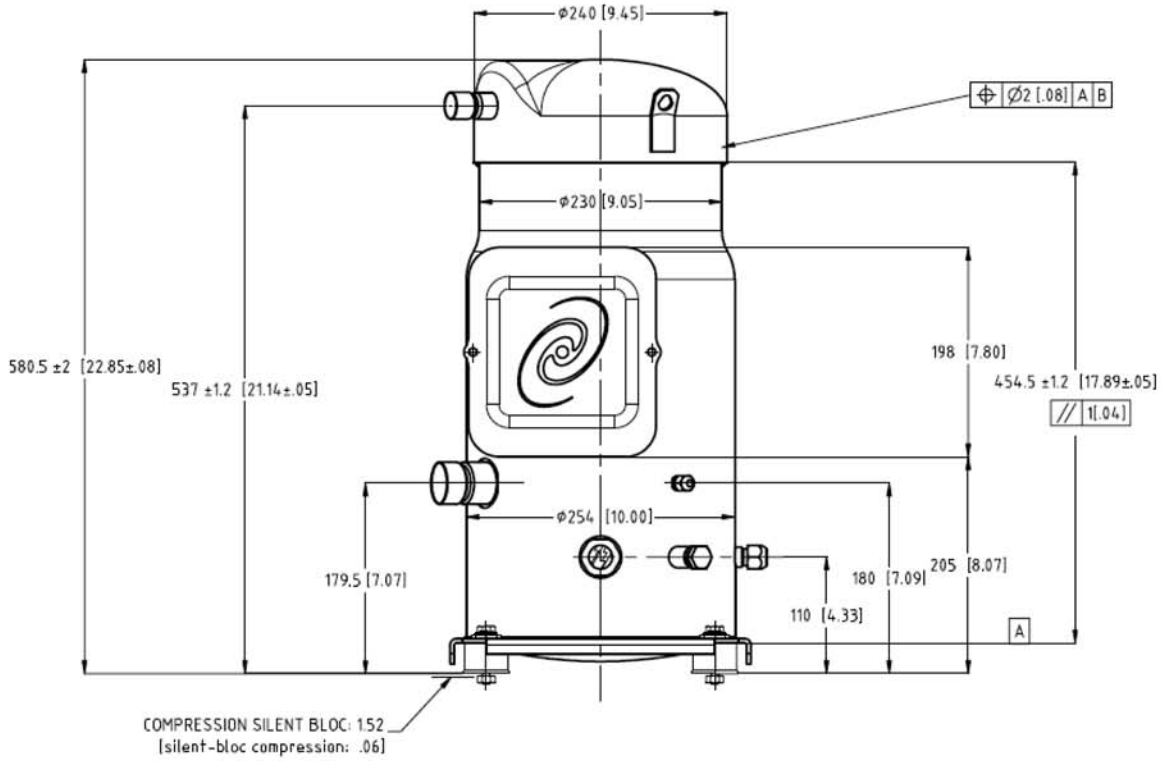

Note: Top mounting bracket not shown

10 Ton—230V

General Characteristics

Model Number	SM125-3QAI
Trane Model	CSHA100J & R
Capacity at rating conditions	125,000 BTU/hr
Suction and discharge Connections	Brazed
Suction connection	1-3/8" ODF
Discharge connection	7/8" ODF
Oil sight glass	Threaded
Oil equalization line	3/8" tube
Oil drain connection	1/4" NPT
LP gauge port	None
IPR valve	None
Swept volume	10.17 in ³ /rev
Displacement @ Nominal speed	1236 cfm @ 3500 rpm
Net weight	172 lbs
Oil charge	128 oz Mineral - 160P
Maximum system test pressure Low Side / High Side	363 psi / 464 psi
Maximum differential test pressure	348 psi
Maximum number of starts per hour	12
Refrigerant charge limit	24 lbs
Approved refrigerant	R22

Electrical Characteristics

Nominal voltage	200-230V/3/60Hz
Voltage range	180-253V
Winding resistance (between phases) +/- 7% at 77F	0.26 Ohm
Maximum Must Trip current (MMT)	52 A
Locked Rotor Amps (LRA)	265 A
Motor protection	Internal thermostat, ext. overload protector needed

Recommended Installation Torques

Oil sight glass	37 ft. lbs
Power connections / Earth connection	2 ft. lbs / 1 ft. lbs
Terminal box cover screws	2 ft. lbs
Mounting bolts	15 ft. lbs

Dimensions

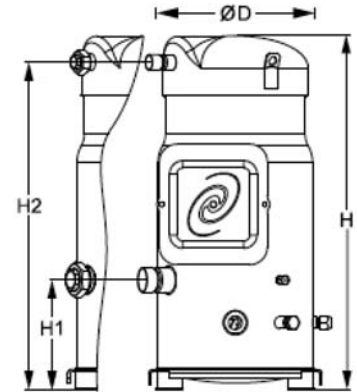

D=10 inch, H=23.1 inch,
H1=7.1 inch, H2=21.2 inch

Terminal box

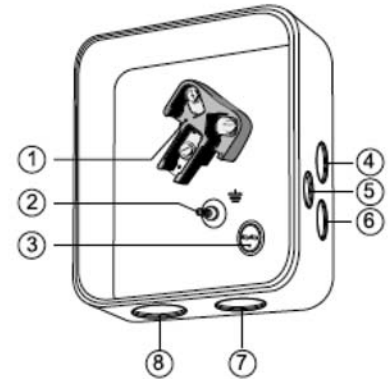

IP54 (with cable gland)

- 1: Power connection, 3 x 4.8 mm (3/16")
- 2: Earth M5, torque 2 Nm (17 in.lb)
- 3: Thermostat connector
- 4: Knock-out Ø 22 mm (7/8") for 1/2" conduit
- 5: Knock-out Ø 16.5 mm (0.65")
- 6: Knock-out Ø 20.5 mm (0.81")
- 7: Double knock-out Ø 32.1 mm (1.26") & Ø 25.4 mm (1")
- 8: Double knock-out Ø 44 mm (1-3/4") for 1-1/4" conduit & Ø 34 mm (1-3/8") for 1" conduit

10 Ton—230V

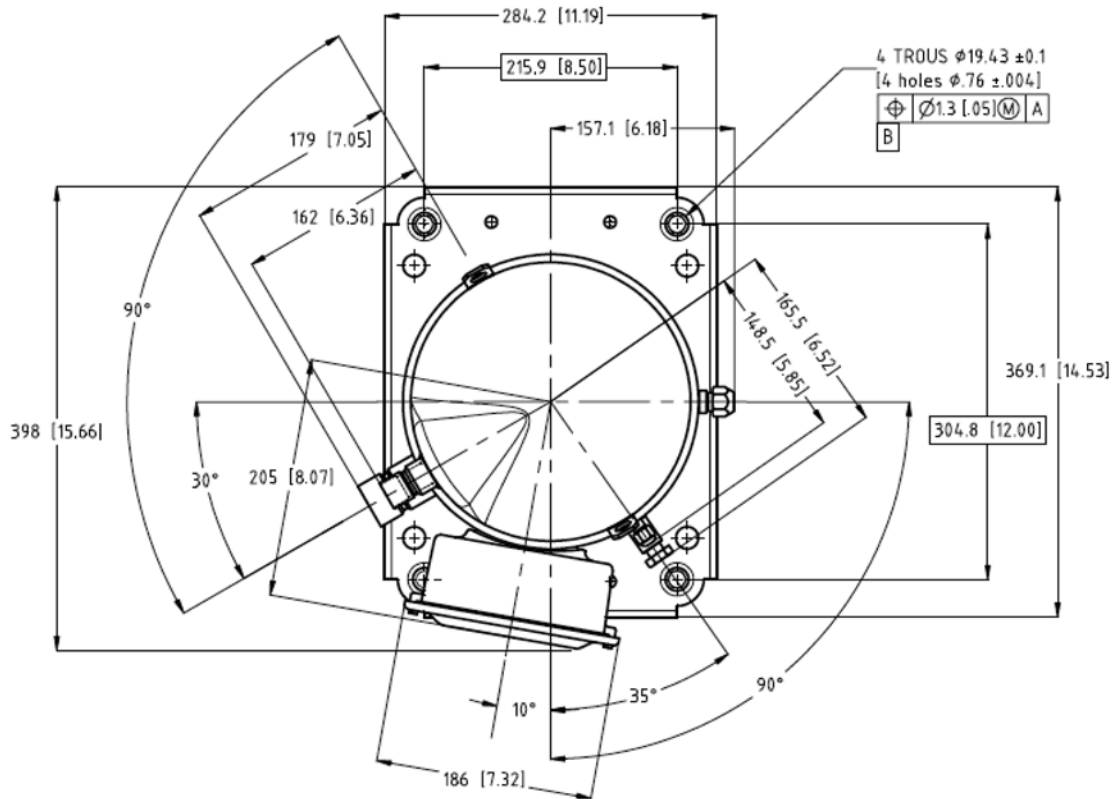
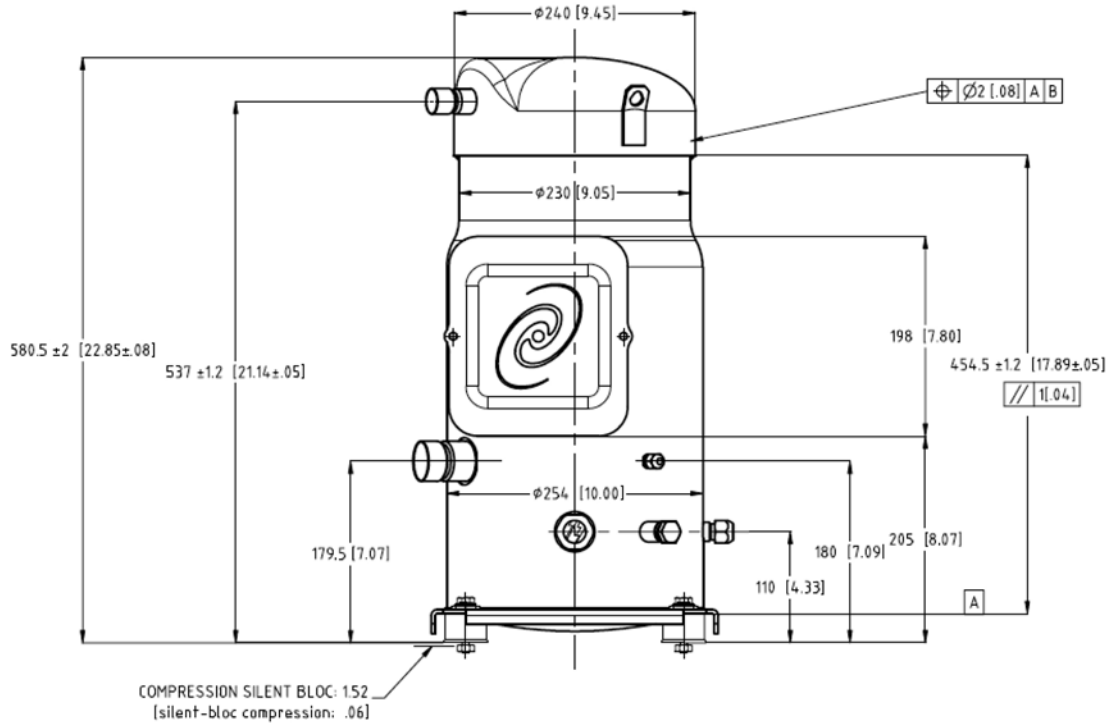

Note: Top mounting bracket not shown

10 Ton—460V

General Characteristics

Model Number	SM125-4QAI
Trane Model	CSHA100K
Capacity at rating conditions	125,000 BTU/hr
Suction and discharge Connections	Brazed
Suction connection	1-3/8" ODF
Discharge connection	7/8" ODF
Oil sight glass	Threaded
Oil equalization line	3/8" tube
Oil drain connection	1/4" NPT
LP gauge port	None
IPR valve	None
Swept volume	10.17 in ³ /rev
Displacement @ Nominal speed	1236 cfm @ 3500 rpm
Net weight	172 lbs
Oil charge	128 oz Mineral - 160P
Maximum system test pressure Low Side / High Side	363 psi / 464 psi
Maximum differential test pressure	348 psi
Maximum number of starts per hour	12
Refrigerant charge limit	24 lbs
Approved refrigerant	R22

Electrical Characteristics

Nominal voltage	460V/3/60Hz
Voltage range	414-506V
Winding resistance (between phases) +/- 7% at 77F	1.16 Ohm
Maximum Must Trip current (MMT)	25 A
Locked Rotor Amps (LRA)	120 A
Motor protection	Internal thermostat, ext. overload protector needed

Recommended Installation Torques

Oil sight glass	37 ft. lbs
Power connections / Earth connection	2 ft. lbs / 1 ft. lbs
Terminal box cover screws	2 ft. lbs
Mounting bolts	15 ft. lbs

Dimensions

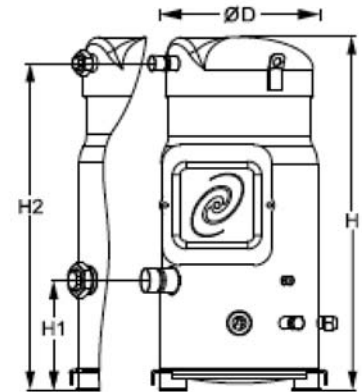

D=10 inch, H=23.1 inch,
H1=7.1 inch, H2=21.2 inch

Terminal box

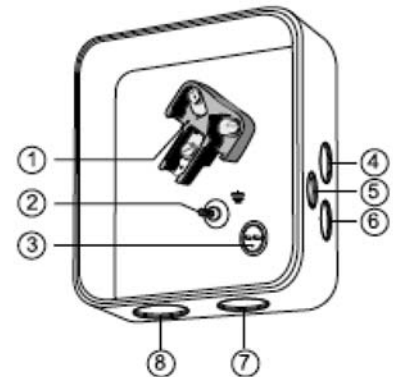

IP54 (with cable gland)

- 1: Power connection, 3 x 4.8 mm (3/16")
- 2: Earth M5, torque 2 Nm (17 in.lb)
- 3: Thermostat connector
- 4: Knock-out Ø 22 mm (7/8") for 1/2" conduit
- 5: Knock-out Ø 16.5 mm (0.65")
- 6: Knock-out Ø 20.5 mm (0.81")
- 7: Double knock-out Ø 32.1 mm (1.26") & Ø 25.4 mm (1")
- 8: Double knock-out Ø 44 mm (1-3/4") for 1-1/4" conduit & Ø 34 mm (1-3/8") for 1" conduit

10 Ton—460V

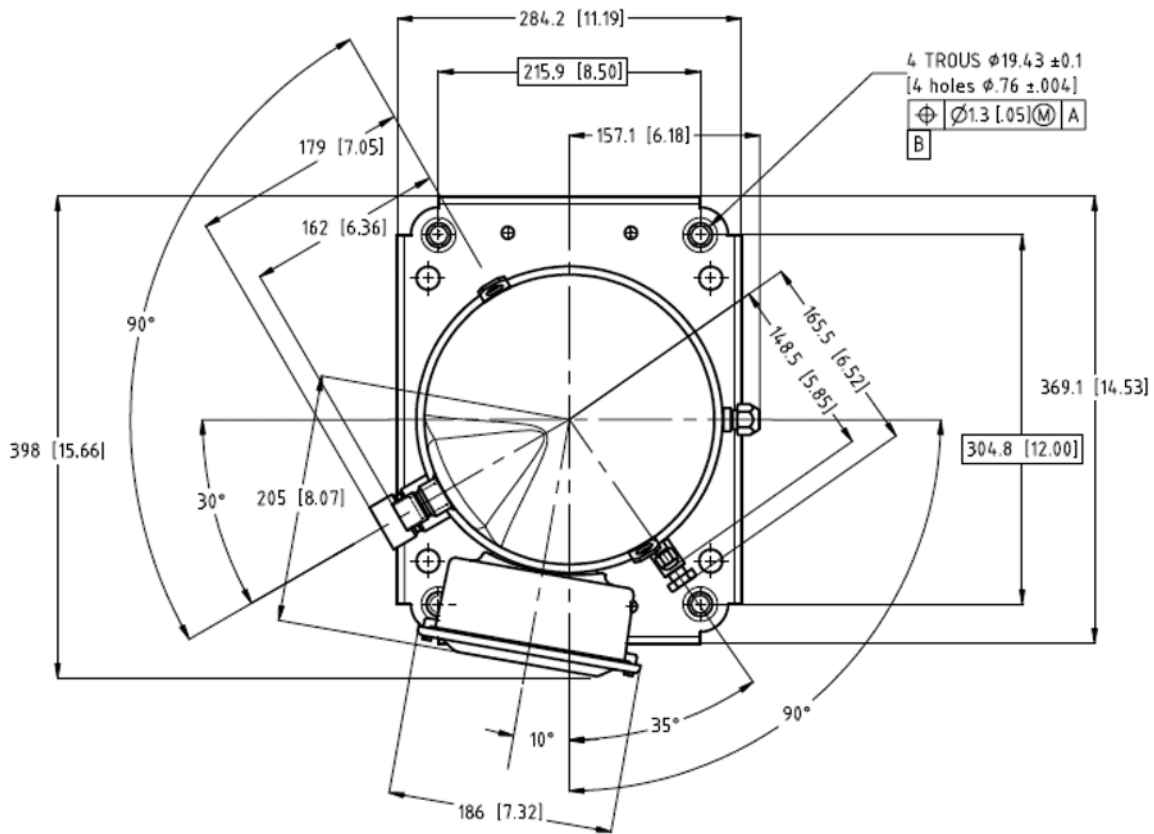
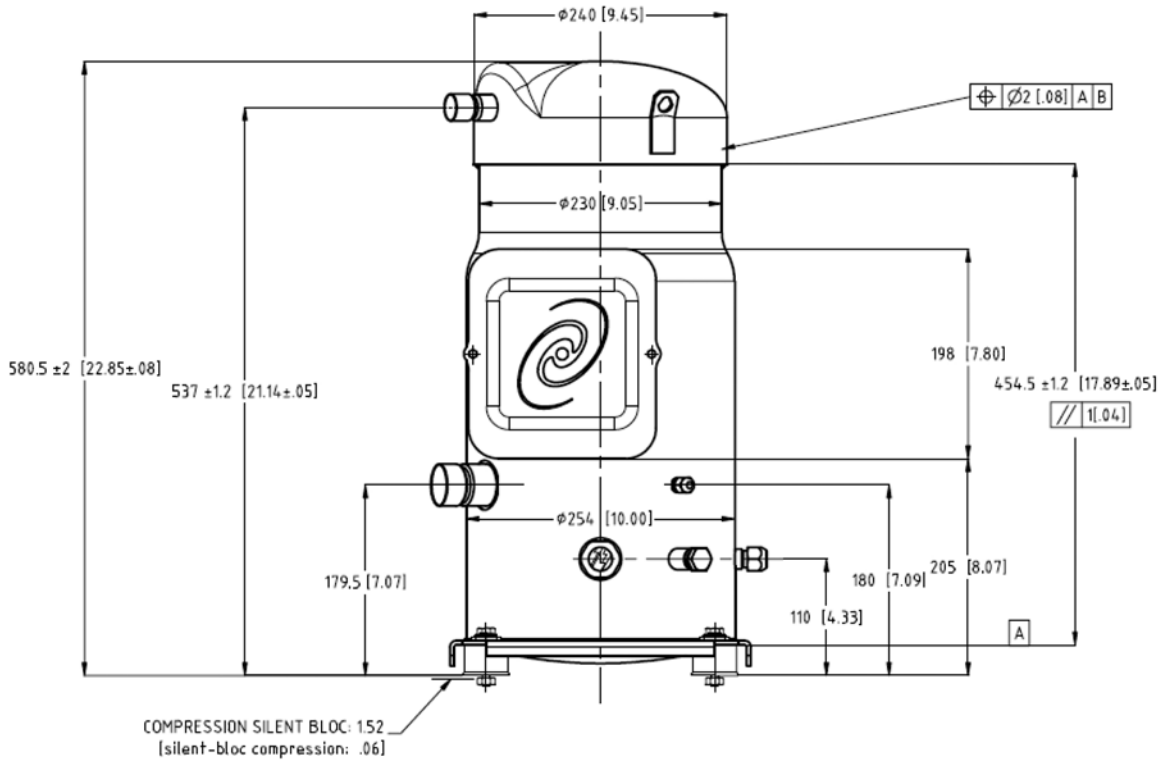

Note: Top mounting bracket not shown

14 Ton—230V

General Characteristics

Model Number	SM175-3QAI
Trane Model	CSHA140J & R
Capacity at rating conditions	175,000 BTU/hr
Suction and discharge Connections	Brazed
Suction connection	1-5/8" ODF
Discharge connection	1-1/8" ODF
Oil sight glass	Threaded
Oil equalization line	3/8" tube
Oil drain connection	1/4" NPT
LP gauge port	None
IPR valve	None
Swept volume	14.22 in ³ /rev
Displacement @ Nominal speed	1728 cfm @ 3500 rpm
Net weight	220 lbs
Oil charge	210 oz Mineral - 160P
Maximum system test pressure Low Side / High Side	363 psi / 464 psi
Maximum differential test pressure	348 psi
Maximum number of starts per hour	12
Refrigerant charge limit	30 lbs
Approved refrigerant	R22

Electrical Characteristics

Nominal voltage	200-230V/3/60Hz
Voltage range	180-253V
Winding resistance (between phases) +/- 7% at 77F	0.19 Ohm
Maximum Must Trip current (MMT)	75 A
Locked Rotor Amps (LRA)	380 A
Motor protection	Internal thermostat, ext. overload protector needed

Recommended Installation Torques

Oil sight glass	37 ft. lbs
Power connections / Earth connection	2 ft. lbs / 1 ft. lbs
Terminal box cover screws	2 ft. lbs
Mounting bolts	15 ft. lbs

Dimensions

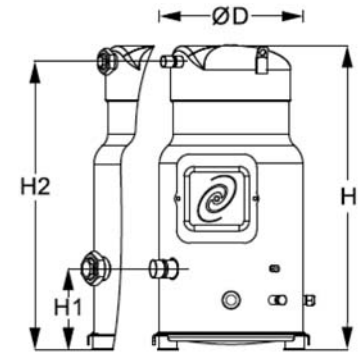

D=12.5 inch, H=26.7 inch,
H1=7.1 inch, H2=25.2 inch

Terminal box

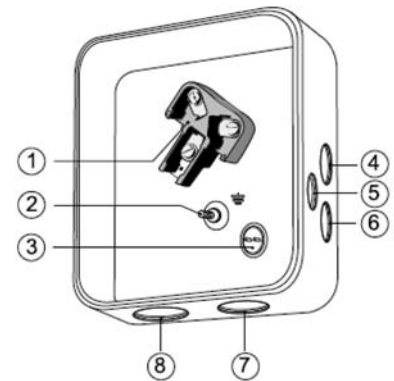

IP54 (with cable gland)

- 1: Power connection, 3 x 4.8 mm (3/16")
- 2: Earth M5, torque 2 Nm (17 in.lb)
- 3: Thermostat connector
- 4: Knock-out Ø 22 mm (7/8") for 1/2" conduit
- 5: Knock-out Ø 16.5 mm (0.65")
- 6: Knock-out Ø 20.5 mm (0.81")
- 7: Double knock-out Ø 32.1 mm (1.26") & Ø 25.4 mm (1")
- 8: Double knock-out Ø 44 mm (1-3/4") for 1-1/4" conduit & Ø 34 mm (1-3/8") for 1" conduit

14 Ton—230V

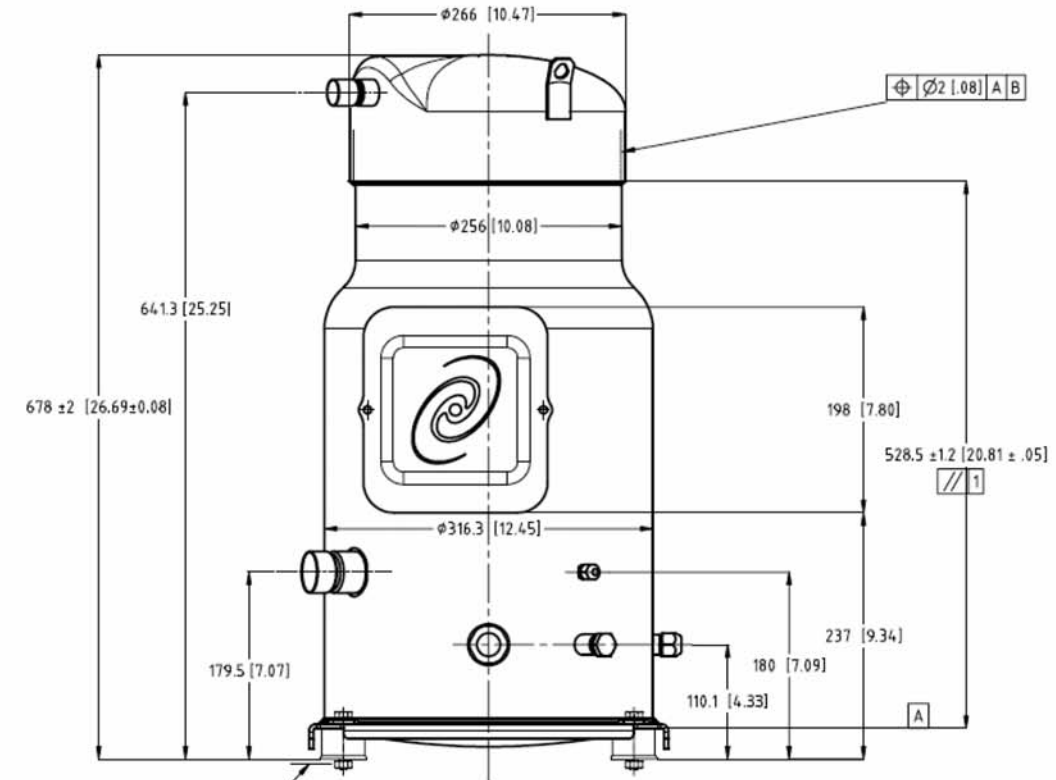

COMPRESSION SILENT BLOC: 152
[silent-bloc compression: .06]

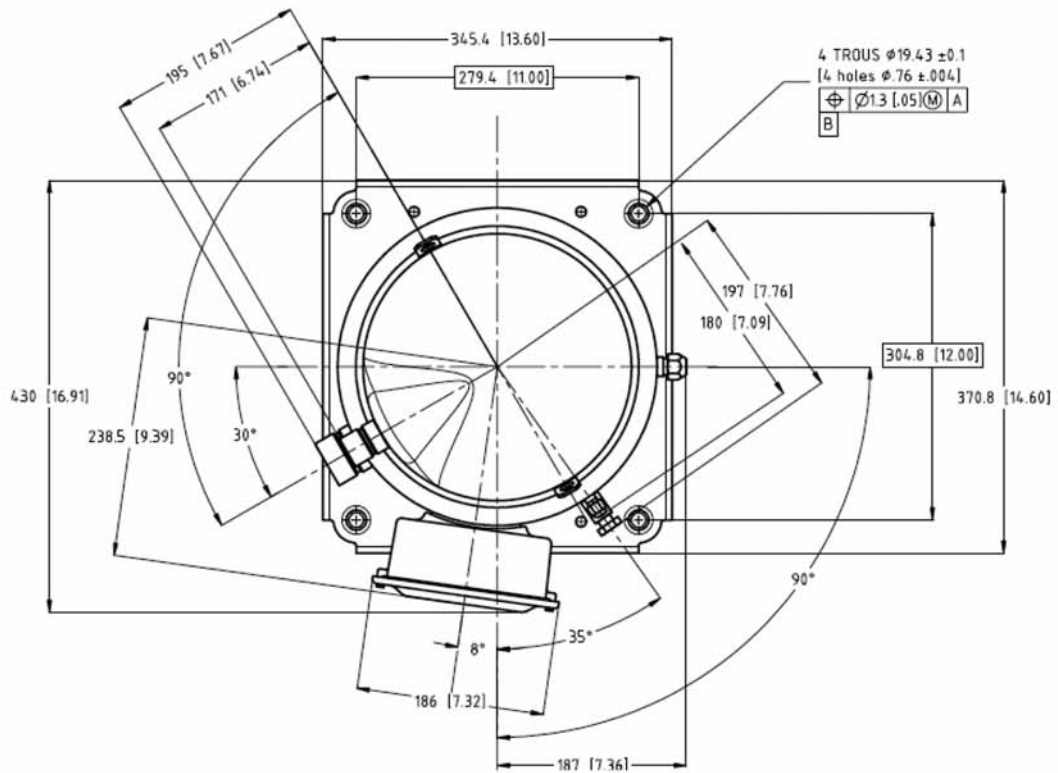

Note: Top mounting bracket not shown

14 Ton—460V

General Characteristics

Model Number	SM175-4QAI
Trane Model	CSHA140K
Capacity at rating conditions	175,000 BTU/hr
Suction and discharge Connections	Brazed
Suction connection	1-5/8" ODF
Discharge connection	1-1/8" ODF
Oil sight glass	Threaded
Oil equalization line	3/8" tube
Oil drain connection	1/4" NPT
LP gauge port	None
IPR valve	None
Swept volume	14.22 in ³ /rev
Displacement @ Nominal speed	1728 cfm @ 3500 rpm
Net weight	220 lbs
Oil charge	210 oz Mineral - 160P
Maximum system test pressure Low Side / High Side	363 psi / 464 psi
Maximum differential test pressure	348 psi
Maximum number of starts per hour	12
Refrigerant charge limit	30 lbs
Approved refrigerant	R22

Electrical Characteristics

Nominal voltage	460V/3/60Hz
Voltage range	414-506V
Winding resistance (between phases) +/- 7% at 77F	0.77 Ohm
Maximum Must Trip current (MMT)	35 A
Locked Rotor Amps (LRA)	175 A
Motor protection	Internal thermostat, ext. overload protector needed

Recommended Installation Torques

Oil sight glass	37 ft. lbs
Power connections / Earth connection	2 ft. lbs / 1 ft. lbs
Terminal box cover screws	2 ft. lbs
Mounting bolts	15 ft. lbs

Dimensions

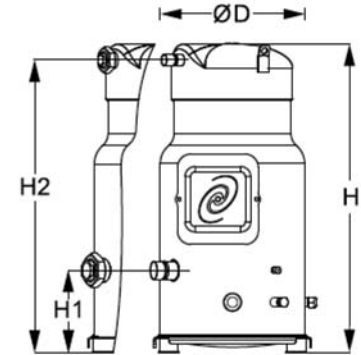

D=12.5 inch, H=26.7 inch,
H1=7.1 inch, H2=25.2 inch

Terminal box

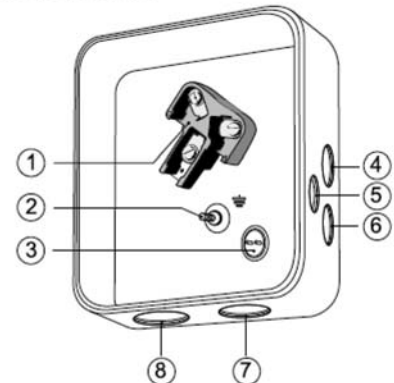

IP54 (with cable gland)

- 1: Power connection, 3 x 4.8 mm (3/16")
- 2: Earth M5, torque 2 Nm (17 in.lb)
- 3: Thermostat connector
- 4: Knock-out Ø 22 mm (7/8") for 1/2" conduit
- 5: Knock-out Ø 16.5 mm (0.65")
- 6: Knock-out Ø 20.5 mm (0.81")
- 7: Double knock-out Ø 32.1 mm (1.26") & Ø 25.4 mm (1")
- 8: Double knock-out Ø 44 mm (1-3/4") for 1-1/4" conduit & Ø 34 mm (1-3/8") for 1" conduit

14 Ton—460V

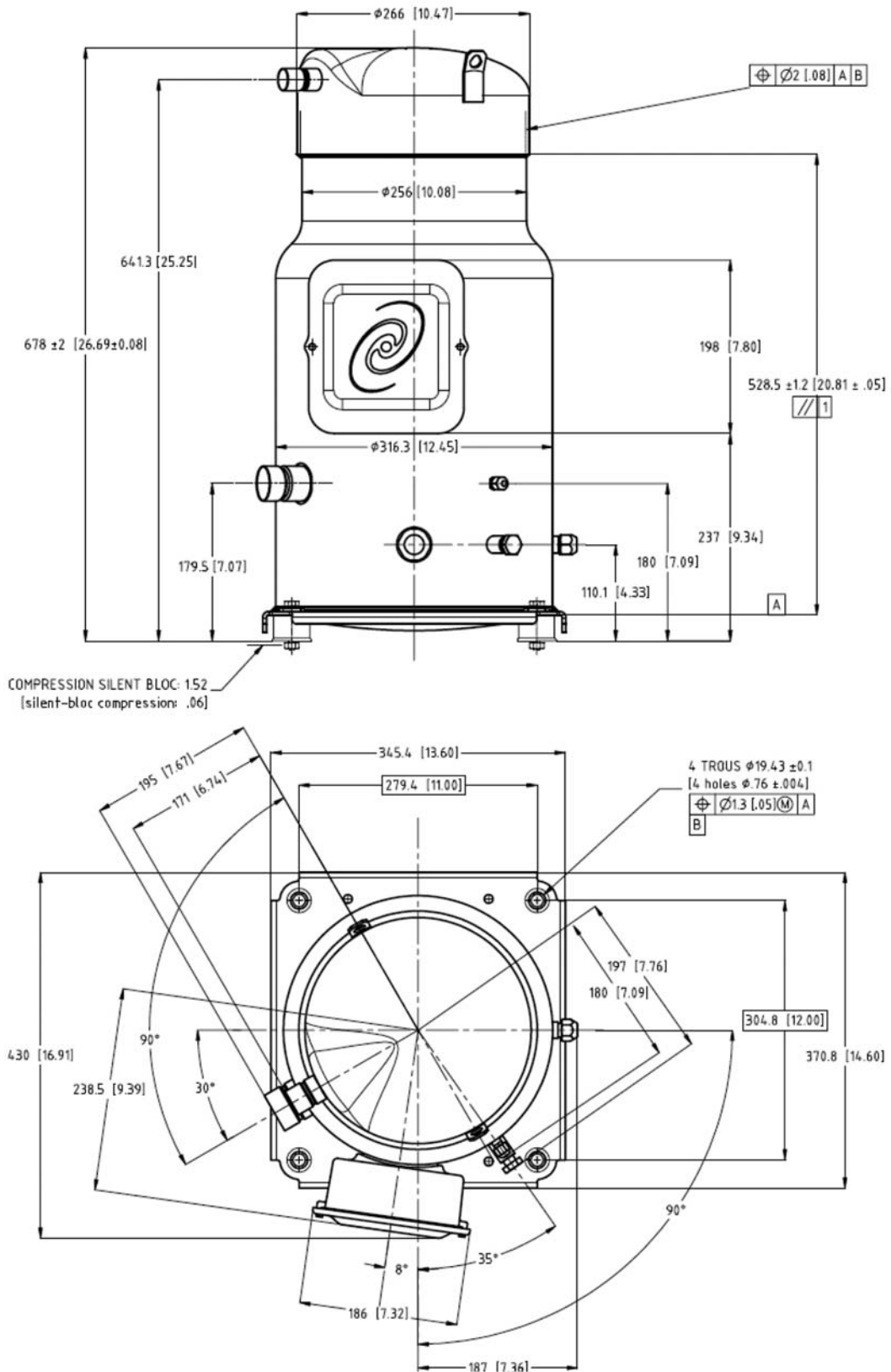

Note: Top mounting bracket not shown

15 Ton—230V

General Characteristics

Model Number	SM185-3QAI
Trane Model	CSHA150J & R
Capacity at rating conditions	185,000 BTU/hr
Suction and discharge Connections	Brazed
Suction connection	1-5/8" ODF
Discharge connection	1-1/8" ODF
Oil sight glass	Threaded
Oil equalization line	3/8" tube
Oil drain connection	1/4" NPT
LP gauge port	None
IPR valve	None
Swept volume	14.22 in ³ /rev
Displacement @ Nominal speed	1853 cfm @ 3500 rpm
Net weight	220 lbs
Oil charge	210 oz Mineral - 160P
Maximum system test pressure Low Side / High Side	363 psi / 464 psi
Maximum differential test pressure	348 psi
Maximum number of starts per hour	12
Refrigerant charge limit	30 lbs
Approved refrigerant	R22

Electrical Characteristics

Nominal voltage	200-230V/3/60Hz
Voltage range	180-253V
Winding resistance (between phases) +/- 7% at 77F	0.19 Ohm
Maximum Must Trip current (MMT)	75 A
Locked Rotor Amps (LRA)	380 A
Motor protection	Internal thermostat, ext. overload protector needed

Recommended Installation Torques

Oil sight glass	37 ft. lbs
Power connections / Earth connection	2 ft. lbs / 1 ft. lbs
Terminal box cover screws	2 ft. lbs
Mounting bolts	15 ft. lbs

Dimensions

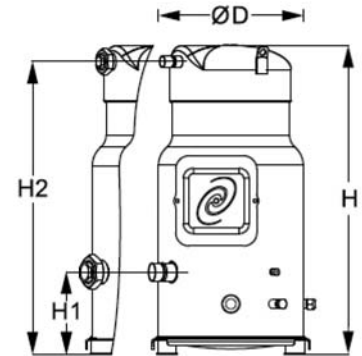

D=12.5 inch, H=26.7 inch,
H1=7.1 inch, H2=25.2 inch

Terminal box

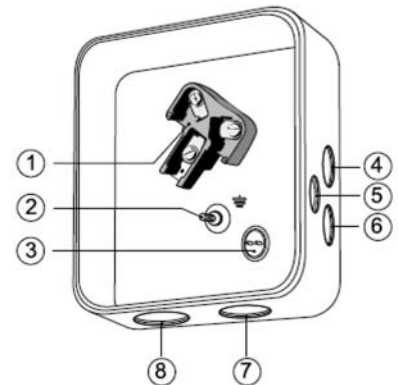

IP54 (with cable gland)

- 1: Power connection, 3 x 4.8 mm (3/16")
- 2: Earth M5, torque 2 Nm (17 in.lb)
- 3: Thermostat connector
- 4: Knock-out Ø 22 mm (7/8") for 1/2" conduit
- 5: Knock-out Ø 16.5 mm (0.65")
- 6: Knock-out Ø 20.5 mm (0.81")
- 7: Double knock-out Ø 32.1 mm (1.26") & Ø 25.4 mm (1")
- 8: Double knock-out Ø 44 mm (1-3/4") for 1-1/4" conduit & Ø 34 mm (1-3/8") for 1" conduit

15 Ton—230V

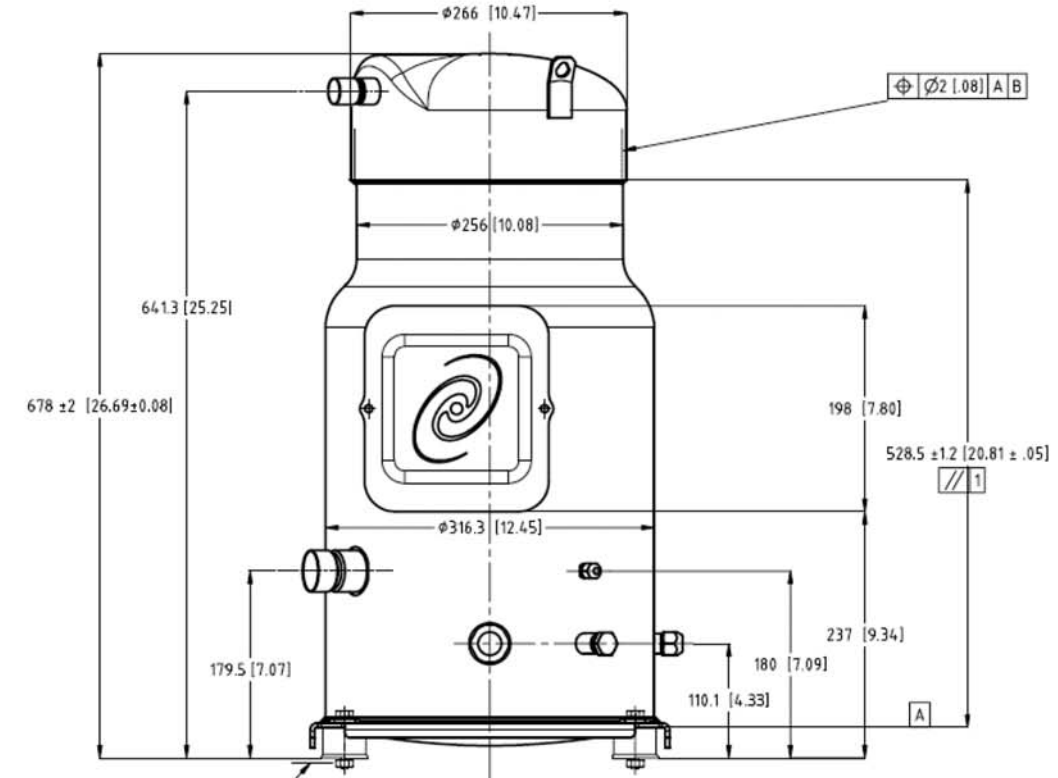

COMPRESSION SILENT BLOC: 152
 [silent-bloc compression: .06]

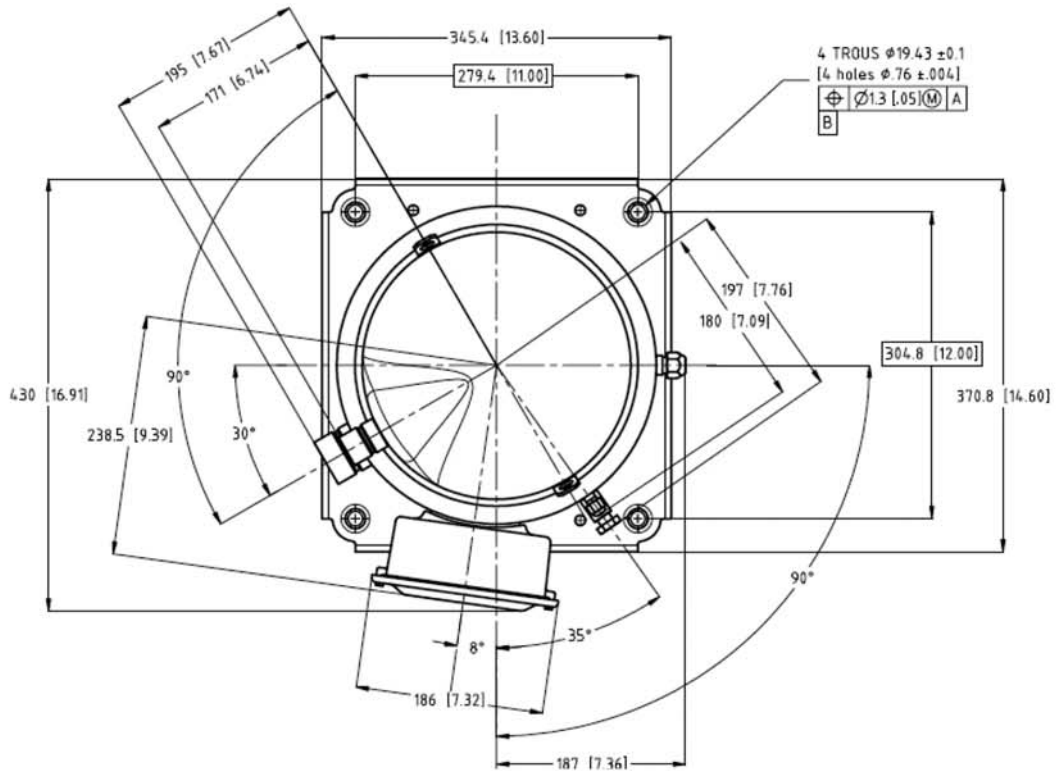

Note: Top mounting bracket not shown

15 Ton—460V

General Characteristics

Model Number	SM185-4QAI
Trane Model	CSHA150K
Capacity at rating conditions	185,000 BTU/hr
Suction and discharge Connections	Brazed
Suction connection	1-5/8" ODF
Discharge connection	1-1/8" ODF
Oil sight glass	Threaded
Oil equalization line	3/8" tube
Oil drain connection	1/4" NPT
LP gauge port	None
IPR valve	None
Swept volume	15.25 in ³ /rev
Displacement @ Nominal speed	1853 cfm @ 3500 rpm
Net weight	220 lbs
Oil charge	210 oz Mineral - 160P
Maximum system test pressure Low Side / High Side	363 psi / 464 psi
Maximum differential test pressure	348 psi
Maximum number of starts per hour	12
Refrigerant charge limit	30 lbs
Approved refrigerant	R22

Electrical Characteristics

Nominal voltage	460V/3/60Hz
Voltage range	414-506V
Winding resistance (between phases) +/- 7% at 77F	0.77 Ohm
Maximum Must Trip current (MMT)	35 A
Locked Rotor Amps (LRA)	175 A
Motor protection	Internal thermostat, ext. overload protector needed

Recommended Installation Torques

Oil sight glass	37 ft. lbs
Power connections / Earth connection	2 ft. lbs / 1 ft. lbs
Terminal box cover screws	2 ft. lbs
Mounting bolts	15 ft. lbs

Dimensions

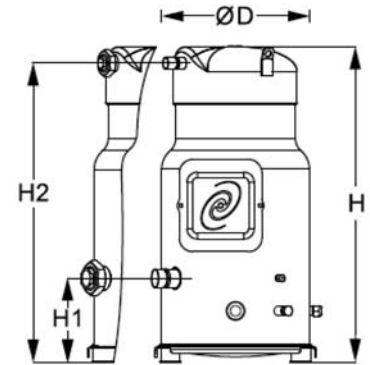

D=12.5 inch, H=26.7 inch,
H1=7.1 inch, H2=25.2 inch

Terminal box

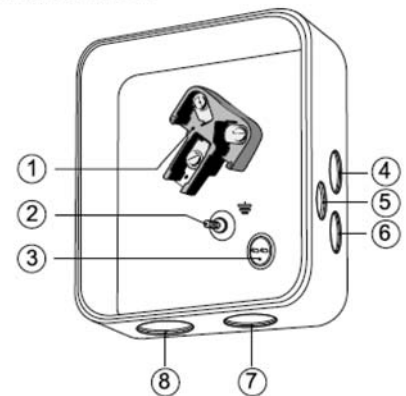

IP54 (with cable gland)

- 1: Power connection, 3 x 4.8 mm (3/16")
- 2: Earth M5, torque 2 Nm (17 in.lb)
- 3: Thermostat connector
- 4: Knock-out Ø 22 mm (7/8") for 1/2" conduit
- 5: Knock-out Ø 16.5 mm (0.65")
- 6: Knock-out Ø 20.5 mm (0.81")
- 7: Double knock-out Ø 32.1 mm (1.26") & Ø 25.4 mm (1")
- 8: Double knock-out Ø 44 mm (1-3/4") for 1-1/4" conduit & Ø 34 mm (1-3/8") for 1" conduit

15 Ton—460V

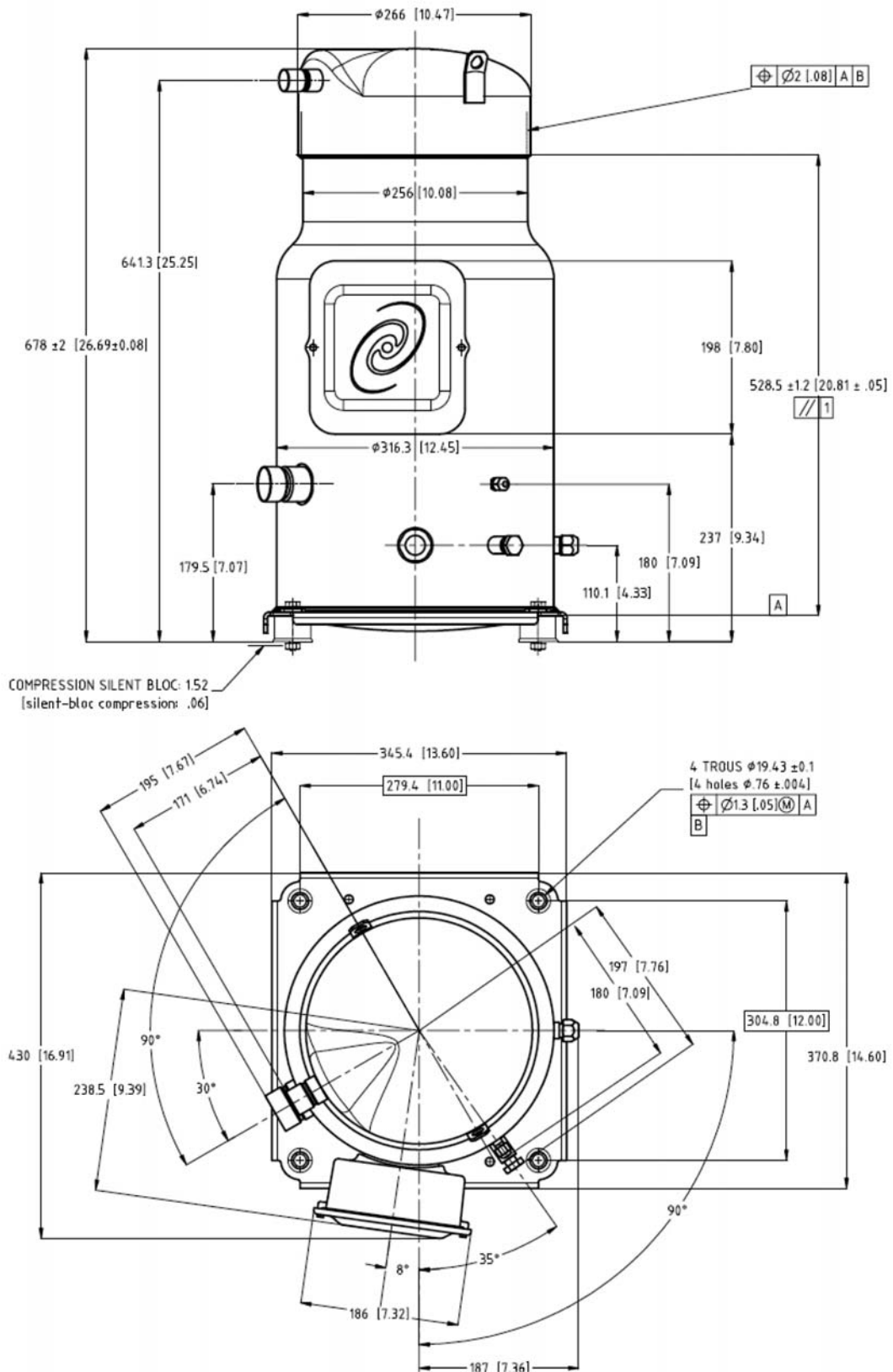

Note: Top mounting bracket not shown

Notes



Notes

Totaline® Is Your Compressor Warehouse



You'll find all the compressors and parts you could ever want all in one place.

